



INSTALLATION INSTRUCTIONS FOR THE CE118S

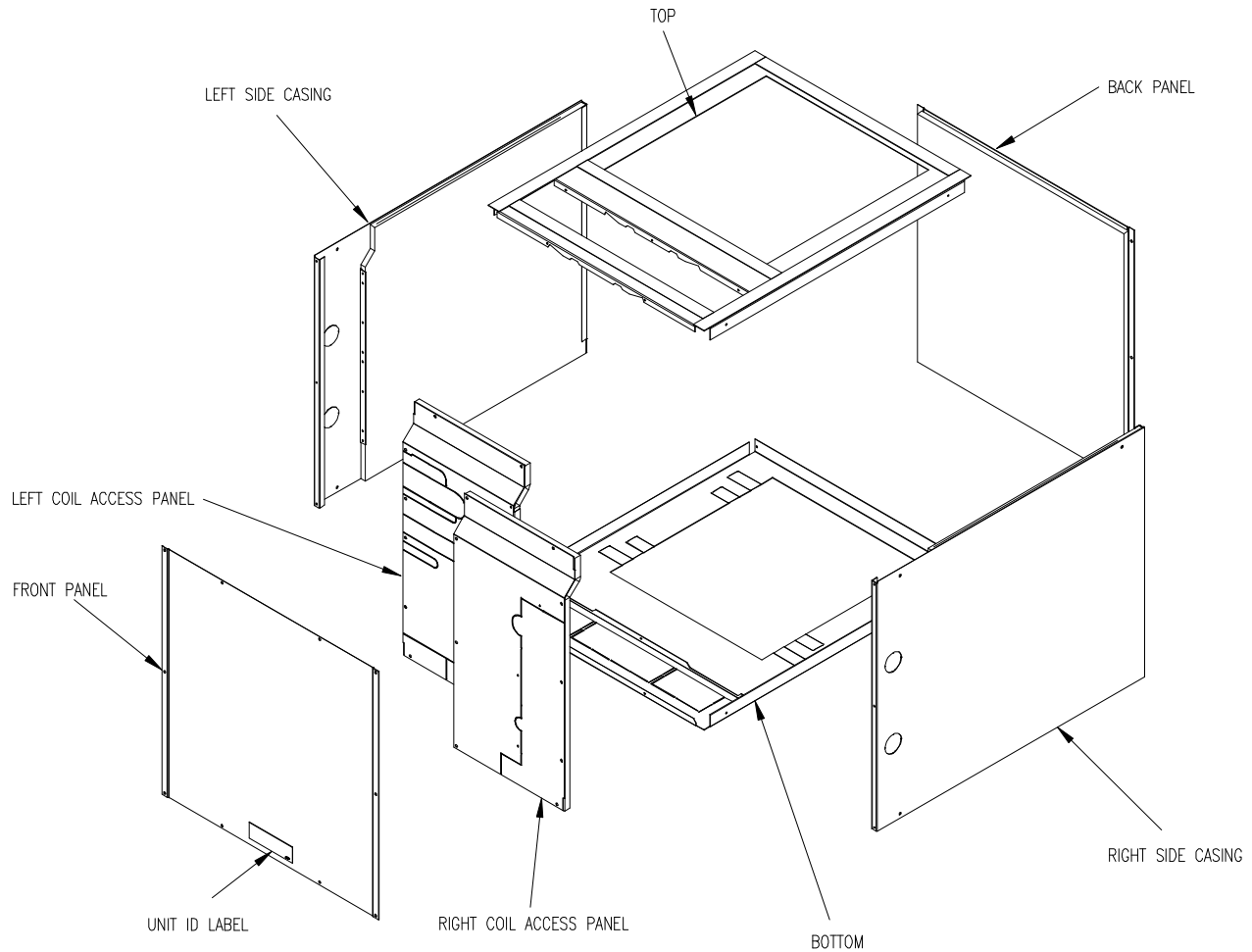

Figure 1

Assembly of Coil Cabinet

1. Place bottom on floor with brakes up. (1/2" brake in front of base).
2. Position side casings so that the brake on base fits between the casing and clip and that the casing is flush with bottom. The refrigerant line knockouts in side casings should be forward toward the 1/2" brake (front) of base.
3. Position the top (brakes down) between the side casing clips and side casings. 1/2" brake is the front of the top.
4. Secure the top and bottom to the side casings using the pre-punched holes with the screws provided.

5. Position the back panel so the back panel brakes will fit against the brakes on side casings. Slide back panel down so that the brake on base fits between clip and panel.
6. Secure interior front coil access panels with offset at the top using the pre-punched holes with screws provided. Then position front panel in a similar fashion as the back panel and secure into place. This step may wait to be completed after the cabinet has been installed and the coil and combustion air duct has been installed.

Installation of Coil Cabinet

Note: If the gas piping is to be installed in the coil cabinet, remove knockout in the base before installing the coil cabinet.

1. For Mobile / Modular Home Installations the cabinet will fit directly on the approved duct connector, See furnace Instruction Manual for approved Duct Connectors.
2. For other installations use base of cabinet as template to cut out openings for supply duct, combustion air duct (for furnace that has thru the floor combustion air), gas and refrigerant lines. Cut holes in floor ¼" larger than holes in base for ducts.
3. Install coil cabinet over floor opening and attach ductwork.

Installation of A-Coil into Cabinet:

1. Remove front panels if not already removed.
2. Slide A-coil into the coil cabinet ensuring that entire opening in the bottom of the A-coil drain pan is over the open area in the bottom of the coil cabinet. Use location tab(s), if applicable, to aid positioning of the coil.
3. Make connections to A-coil refrigerant lines and drain lines.
4. Refer to A-coil evaporator instructions (shipped with coil) to complete the A-coil installation.
5. After the coil and all of the connections have been put in place the interior front panels can be installed. These panels will provide the seal for air flow thru the coil cabinet.

Installation of Furnace on Coil Cabinet:

1. Position Furnace onto coil cabinet, making sure the back of furnace is flush against the back of the coil cabinet lip.
2. Make certain that the duct flanges are completely sealed to the furnace base with high temperature silicone sealant.

Installation of Gas Pipe:

If the gas piping is to run through the coil cabinet a chase is not required. Gas piping can be installed through the front compartment in one piece.

1. Remove knockout in base.
2. Seal the gas pipe where it passes through the base of the coil cabinet.

Refer to **Furnace Installation and Service Instructions** for additional information to complete the installation.